

PZ 67
 $\alpha = 84^\circ$

PZ 64
 $\alpha = 96^\circ$

PACIOREK
 JÓZEF
 KRYSZYNA PZ 65
 $\alpha = 90^\circ$

PZ 67
 $\alpha = 3^\circ$

PZ 66
 $\alpha = 2^\circ$

PZ 65
 $\alpha = 3^\circ$

W-11a

Ø 160 PVC L=125m
 Ø 160 PVC L=86m

22

27/1

26

14.46

175A/5

Ø 32 PE

HP 39

M 41

14.99

14.94

15.07

15.15

15.79

16.09

16.38

16.53

16.51

16.48

16.04

14.98

14.76

14.74

14.67

14.67

14.30

14.58

24

14.84

15.41

15.59

15.90

15.11

15.39

15.26

15.35

15.46

15.23

15.31

15.28

15.18

14.90

Ls

Ls

Ls

Ls

Ls

Ls

Ls

Ls

Ls

Ls

Ls

Ls

Ls

Ls

Ls

Ls

Ls

Ls

Ls

Ls

Ls

Ls

Ls

Ls

Ls

Ls

Ls

Ls

Ls

Ls

Ls

Ls

Ls

Gm. RYJEWÓ WOJ.

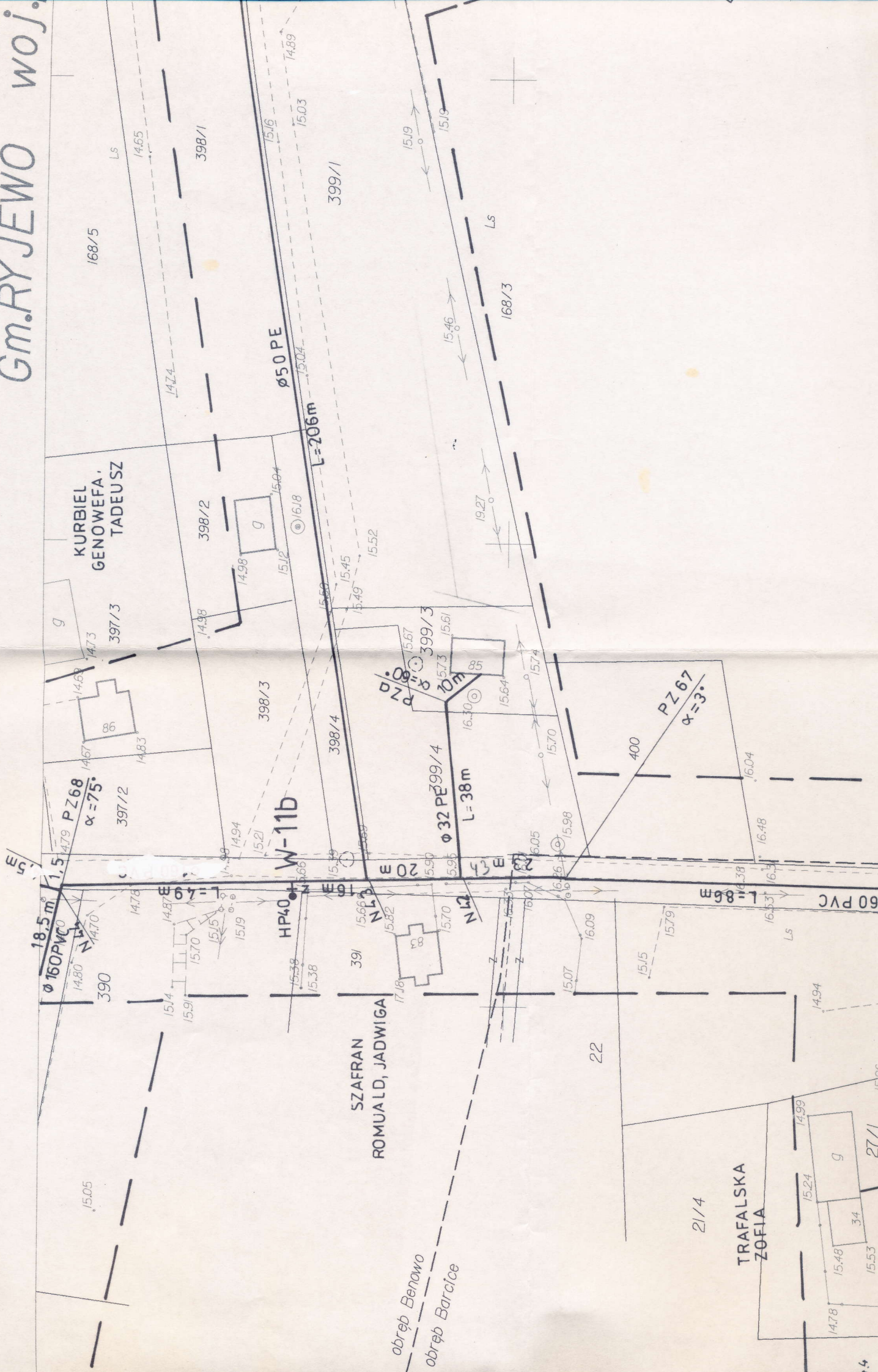

KURBIEL
GENOWEFA,
TADEUSZ

SZAFRAN
ROMUALD, JADWIGA

TRAFALSKA
ZOFIA

Ø50 PE
L=206m

Ø32 PE 99/4
L=38m

Ø60 PVC
L=86m

W-11b

PZ 68
 $\alpha = 75^\circ$

PZ 67
 $\alpha = 3^\circ$

168/5

398/1

399/1

168/3

398/2

398/3

398/4

397/3

397/2

399/3

400

390

391

22

21/4

27/1

obręb Benowo
obręb Barcice

E 57

18.5 m

14.80

14.78

14.87

15.70

15.15

15.19

15.38

15.38

17.18

15.66

15.82

15.70

15.95

16.07

16.26

16.05

15.98

16.09

15.15

15.79

16.33

16.3

16.38

16.48

16.04

14.94

14.69

14.73

14.67

14.83

14.98

14.98

15.12

15.04

15.50

15.49

15.45

15.52

15.67

15.73

15.61

15.64

15.74

15.70

15.98

16.05

16.26

16.09

15.15

15.79

16.33

16.3

16.38

16.48

16.04

14.74

14.65

14.74

14.89

15.16

15.04

15.03

15.19

15.19

15.46

15.19

15.19

15.19

15.19

15.19

15.19

15.19

15.19

15.19

15.19

15.19

15.19

15.19

15.19

15.19

15.19

15.19

15.19

15.19

14.98

14.98

14.98

14.98

14.98

14.98

14.98

14.98

14.98

14.98

14.98

14.98

14.98

14.98

14.98

14.98

14.98

14.98

14.98

14.98

14.98

14.98

14.98

14.98

14.98

14.98

14.98

14.98

14.98

14.67

14.83

14.98

15.12

15.04

15.50

15.49

15.45

15.52

15.67

15.73

15.61

15.64

15.74

15.70

15.98

16.05

16.26

16.09

15.15

15.79

16.33

16.3

16.38

16.48

16.04

14.94

14.78

15.48

15.05

15.14

15.91

15.70

15.15

15.19

15.38

15.38

17.18

15.66

15.82

15.70

15.95

16.07

16.26

16.05

15.98

16.09

15.15

15.79

16.33

16.3

16.38

16.48

16.04

14.94

14.78

15.48

15.53

14.78

15.48

15.53

15.24

14.99

15.05

15.14

15.91

15.70

15.15

15.19

15.38

15.38

17.18

15.66

15.82

15.70

15.95

16.07

16.26

16.05

15.98

16.09

15.15

15.79

16.33

16.3

16.38

16.48

14.78

15.48

15.53

15.24

14.99

15.05

15.14

15.91

15.70

15.15

15.19

15.38

15.38

17.18

15.66

15.82

15.70

15.95

16.07

16.26

16.05

15.98

16.09

15.15

15.79

16.33

16.3

16.38

16.48