

RYSUNKI I SZKICE URZĄDZEŃ SKŁADAJĄCYCH SIĘ NA PLAC ZABAW W RYJEWIE

GMINA RYJEWO

W O J T
mgr Józef Gutowski

HUSTAWKA

PODWOJNA METALOWA

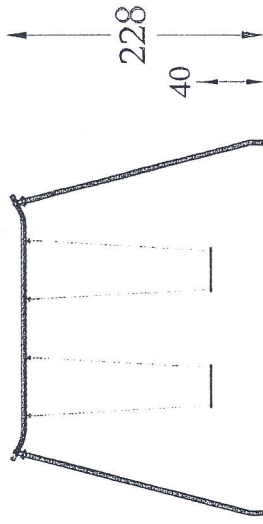
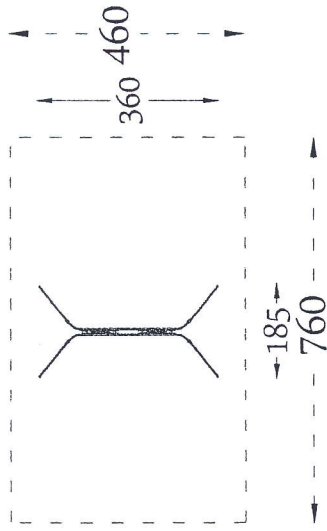
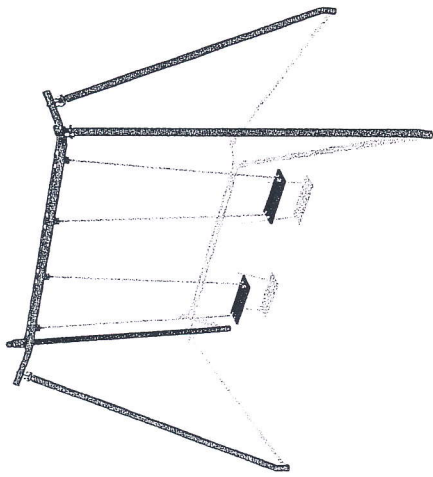

DRABINKA

POZIOMA

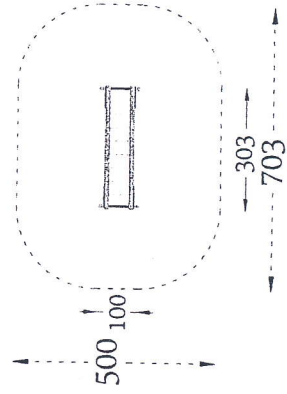
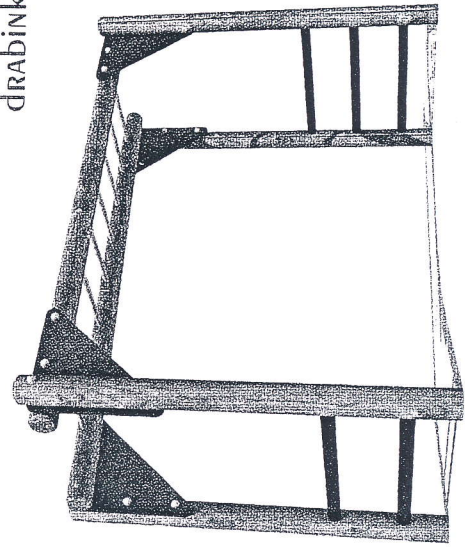

Kółko i krzyżyk

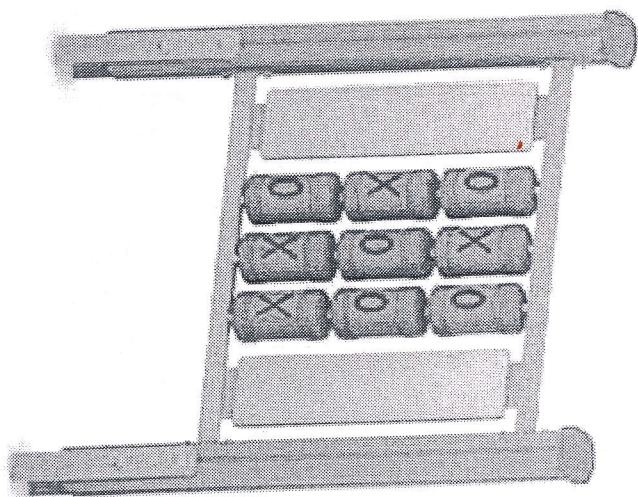

Stopy wykonane z drewna litego.
Stopy stalowe, ocynkowane, betonowane
w gruncie. Stal ocynkowana,
malowana proszkowo. Palisada iglasta,
Laminowana, wodoodporna sklejka
o grubości 15mm.

ławka
Z bali stała z oparciem

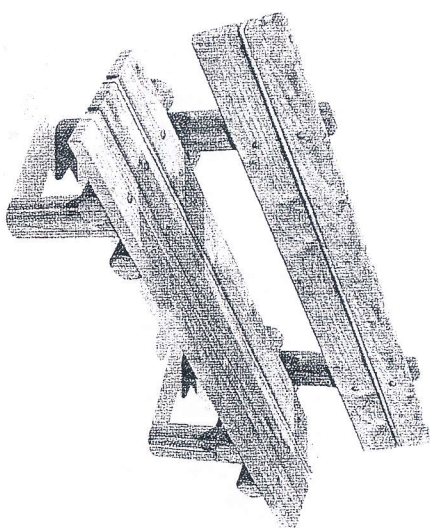

51

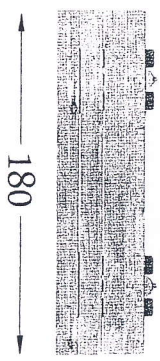

180



45

Aksesoria
Kosz na śmieci z półwałków

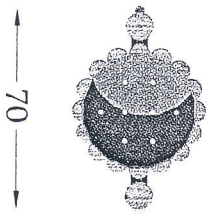
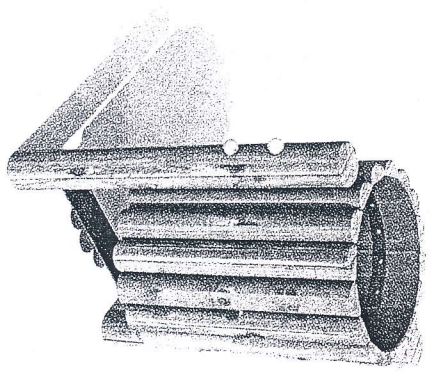

70

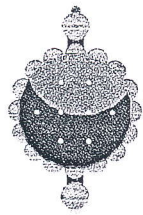

48



91

stolik
Do gry w szachy i chińczyka

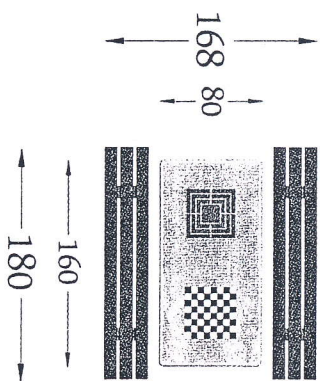
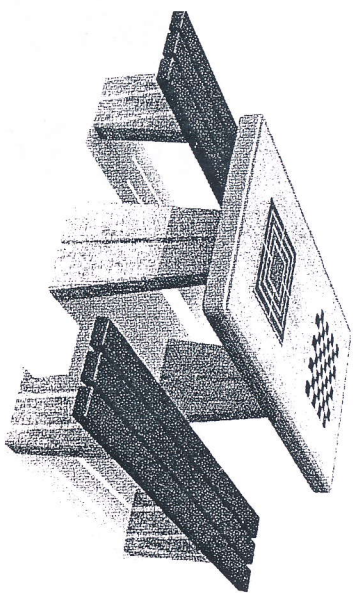

gry
Stół pingpongowy stały

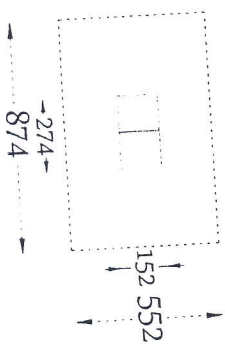
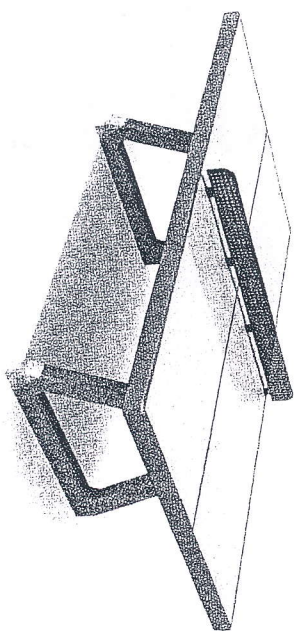

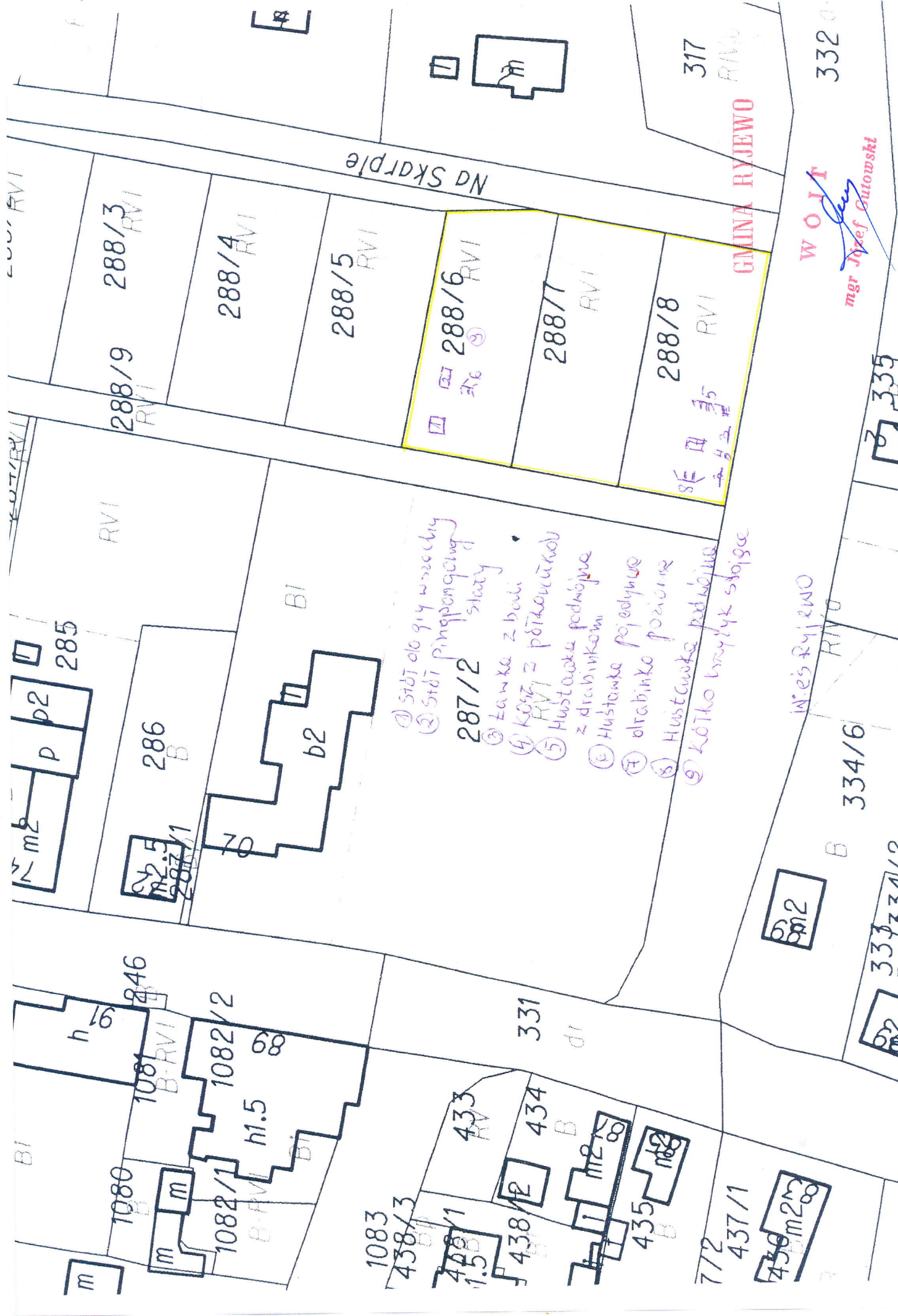

NA SKARPIE

GMINA RYJEWÓ

- 287/2
- ① Stół do gry w szachy
 - ② Stół pingpongowy
 - ③ Ławka z banki
 - ④ Kosz z piłkami
 - ⑤ Huśtawka podłojna z drabinkami
 - ⑥ Huśtawka pojedyncza
 - ⑦ drabinka pozioma
 - ⑧ Huśtawka podłojna
 - ⑨ kółko krzyżyk stojące

W O J T

mgr Józef Gutowski

332

Wies Ryjewo

334/6

334/2

333

317

288/8

288/7

288/6

288/5

288/4

288/3

288/9

285

286

246

1082/2

68

1083

438/3

438/1

433

434

331

772

437/1

436

1080

1081

1082/1

h1.5

h1.6

2 m²

22.5

20.7

70

1

1

p

p2

20.7

BI

b2

BI

B-RVI

B-RVI

BI

dr

RVI

RVI

335

335

335

335

335

335

335

335

335

335

335

335

335

335

335

335

335

335

335

335

335

335

335